

Q-XP PREMIUM SC CONNECTOR APC

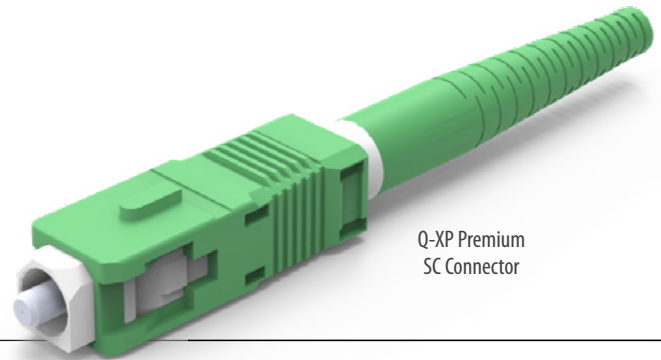

The SENKO Q-XP SC Connector is a high-performance, field-installable connector designed for quick and efficient repairs and installations. It is compatible with the standard SC connector and adheres to GR-1081 for field mountable singlemode fiber optic connectors, ensuring exceptional performance.

Its standout features include the pre-polished, pre-assembled design, which eliminates the need for epoxy curing or polishing of the end face, significantly reducing installation time and effort. The connector uses a highly stable index matching gel to provide optimum performance along with an internal mechanical grip that securely holds the fiber in place.

The SENKO Q-XP SC Connector's superior mechanical and optical characteristics make it an excellent choice for all field applications, providing reliable and high-quality connections. Its user-friendly design and robust performance make it a valuable tool for field technicians, ensuring quick and easy installations with minimal hassle.

FEATURES

- No Adhesives or polishing required
- Pre-polished, pre-assembled
- Compatible with IEC 61754-4
- Internal mechanical splice
- Uses highly stable index matching gel
- Less than 2 minute termination time

APPLICATIONS

- Telecommunications
- Data centers
- Local area networks (LANs)
- FTTX networks
- Premise distribution networks
- Industrial applications

KEY BENEFITS

- ✓ **Simple termination, no adhesives, no polishing**
- ✓ **Does NOT require the use of a fusion splicer**
- ✓ **High quality matching gel**
- ✓ **Quick installation**
- ✓ **Multiple cable suitability**
- ✓ **Color coded housings**

Mechanical Data

	Value
Durability	500 matings
Cable Types	900 μm, 1.65 mm, 2 mm, 3 mm
Intermateability	SC (IEC 61754-4)
Polishing	APC
Fiber Count	Simplex (1 channel)
Tensile IEC 61300-2-6	TIA.EIA 568-C.3

Optical Data

	Singlemode
	APC
Typical Insertion Loss (dB)	0.3
Maximum Insertion Loss (dB)	0.75
Typical Return Loss (dB)	65
Ferrule Diameter (μm)	125

Environmental Data

	Value
Operating Temperature	-40°C to +75°C
RoHS Compliance	Yes
REACH Compliance	Yes
Humidity Resistance	95%

Connector Drawing

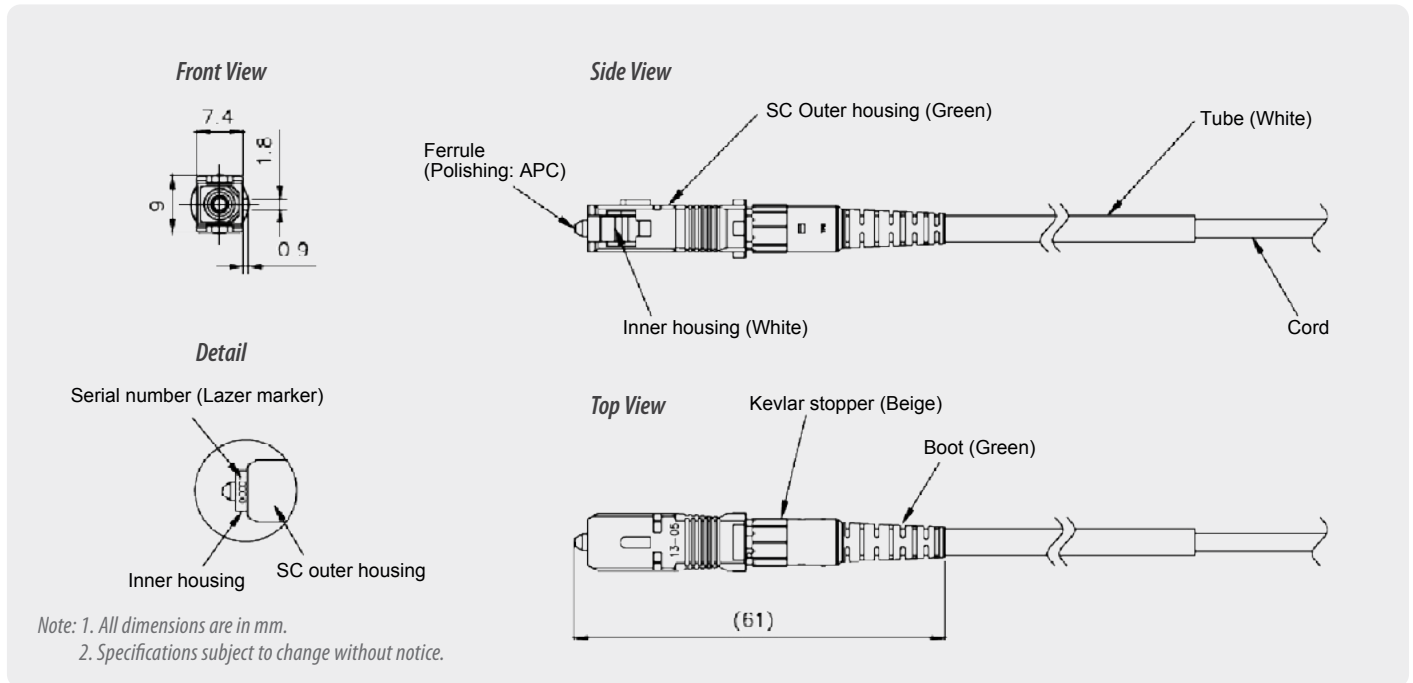

ORDERING

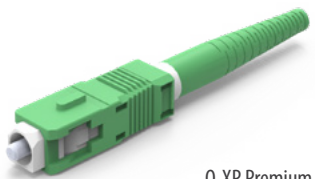

Q-XP Premium SC Connector

CODE	FERRULE TYPE	OUTER HOUSING	BOOT TYPE	BOOT COLOR
QXP Q-XP SC Connector	091 SM: APC	4 Green	1 900 μm 2 1.65 mm 3 2.0 mm 4 3.0 mm	3 Green

QXP 091 413 ORDER CODE example

Note: 1. The connector performance specifications include an internal mechanical splice
2. Typical specification values are at 23°C ±5°C

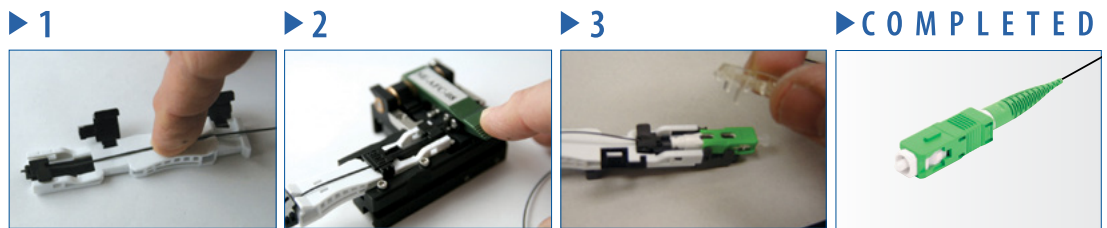

Accessories - Production/Cleaning

Smart Cleaner™

Cassette

PN: SCK-CC-100

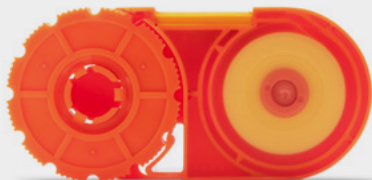

Smart Cleaner™

2.5 mm Clicker

PN: SCK-SS-250

Refill PN: SCK-SS-250-R



SC Crimp Tool

PN: CRT-401 SC, FC, ST One Piece Connectors

CRT-501 SC Connector Kit 132 Series

CRT-705 SC/LC 1.2 mm Connector



2.5 mm NEOCLEAN Cleaning Stick

PN: CSK-02

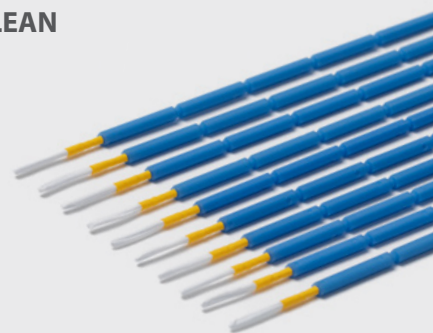

Accessories - Interferometry

SUMIX Max W+ Inspection Scope

PN: SMX-MANTA-W+



The MANTA W+ inspection scope is designed for high-performance inspection of all types of single fiber and multi-fiber optical connectors, patch cords and bulkheads. The MANTA HM inspection scope is used to detect scratches, contamination and other surface defects as small as 0.75 μm on the end face of the connector.

SUMIX Max QM+ Inspection Scope

PN: MAX-QM+



The MAX-QS+ is a white-light and phase-shift interferometer for inspection of single fiber ST, FC, SC, LC, CS, SN, E2000™ (PC and APC), small format multi-fiber MT-RJ (PC and APC), SMA and special connectors. MAX-QS+ features portable design, autofocus, 100 micron scan range for fiber height and resolution of 1.1 μm .

Contact sales@senko.com
or visit our website for more details

Contact
SENKO

SENKO[®]

Advanced Components

sales@senko.com
1-858-623-3300

senko.com/contact